

# KEMPSEY (KY)

(30)

3(S)S CONTROLLED BY SHUNTER'S PUSH BUTTON AT FRAME C

OH

THIS SIGNAL MUST NOT BE PASSED AT STOP WITHOUT AUTHORITY FROM SIGNALLER

3(S)M-'M'  
3(S)L-'L'  
3(S)S-'S'

3M-'M'  
3L-'L'  
3S-'S'

FRAME G  
RELEASED BY KEY FROM RELEASING SWITCH G OR REL LOCK G

FRAME C  
RELEASED BY KEY FROM RELEASING SWITCH C OR REL LOCK C

EMERGENCY RELEASE LOCKS

MANUAL OP. SW. EMERG. SWITCHES. TEST SWITCH. TELEPHONE.

52 EOL  
HALF PILOT STAFF LOCK

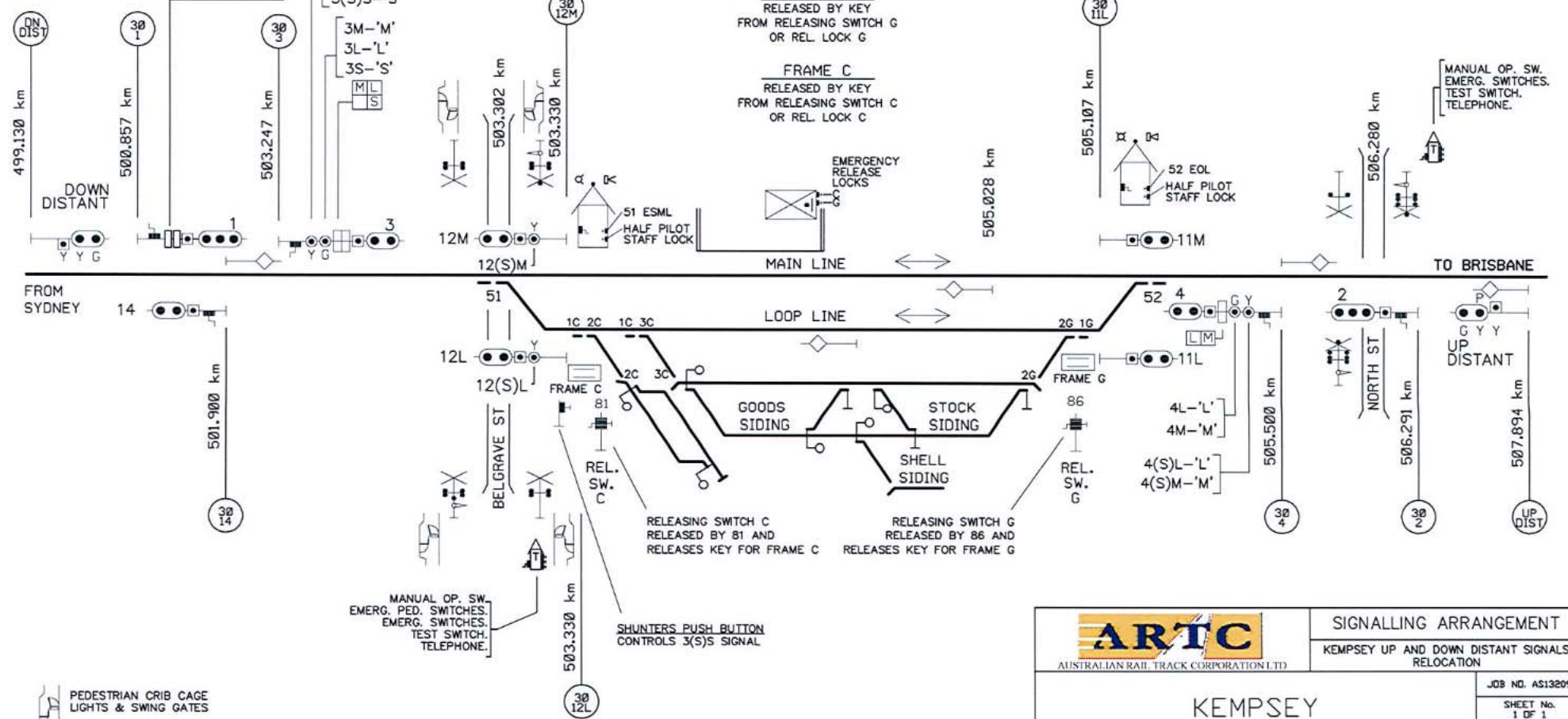

KEMPSEY  
C33R21100.DWG

KEMPSEY  
C33R21100.DWG



SIGNALLING ARRANGEMENT  
KEMPSEY UP AND DOWN DISTANT SIGNALS  
RELOCATION

## KEMPSEY DRIVERS DIAGRAM

JOB NO. AS13209
SHEET No. 1 OF 1
VERSION DATE 01/11/2013
PRODUCED BY UTS RAIL

NOT TO SCALE

PEDESTRIAN CRIB CAGE  
LIGHTS & SWING GATES