

FRAME B
 RELEASES BY KEY FROM REL. SW B OUT WITH LEVER
 NORMAL OR KEY FROM RELEASING LOCK B

RELEASING SWITCH B
 RELEASED BY 81 & RELEASES KEY FOR FRAME B.

KENDALL (KL) (25)

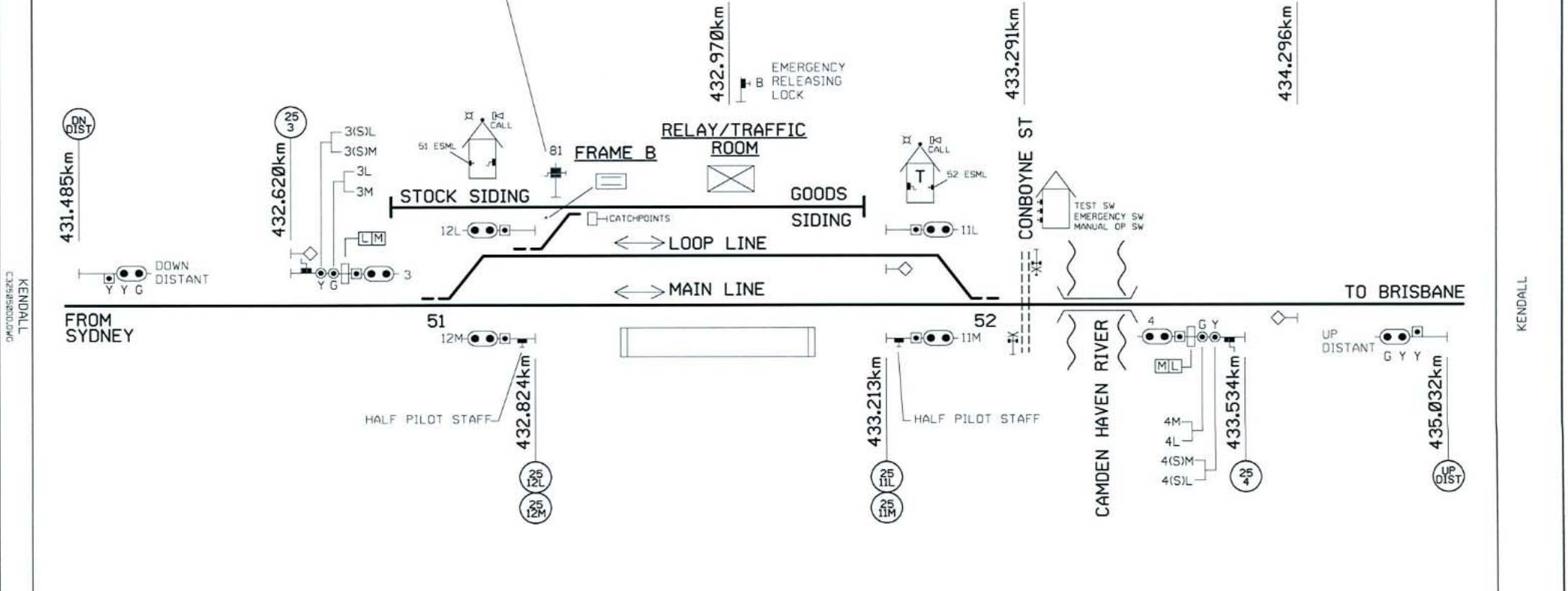

 AUSTRALIAN RAIL TRACK CORPORATION LTD.	SIGNALLING ARRANGEMENT	
	RELOCATION OF UP AND DOWN DISTANT SIGNALS	
<h2>KENDALL DRIVERS DIAGRAM</h2>	JOB NO. AS 13207	
	SHEET No. 1 OF 1	
	VERSION DATE 24.11.13	
	PRODUCED BY UTS RAIL	
NOT TO SCALE		