

FOR CONTINUATION REFER TO NEWPORT to ALTONA JUNCTION SIGNALLING DIAGRAM

FOR CONTINUATION REFER TO PAISLEY to MANOR SIGNALLING DIAGRAM

All dimension in metres.
Siding dimensions indicate standing room clear of crossing & adjacent tracks
HS indicates High Speed Points

Pilot staff shown

Distance from signal to level crossing denoted this 'Xm to LX'



ALTONA JUNCTION - WESTONA - LAVERTON SIGNALLING DIAGRAM No. 43/10

(Replaces No. 27/10)

Showing Signal and Interlocking Arrangements to come into use on a date to be fixed by Circular which will be issued by the Manager Rail Safety

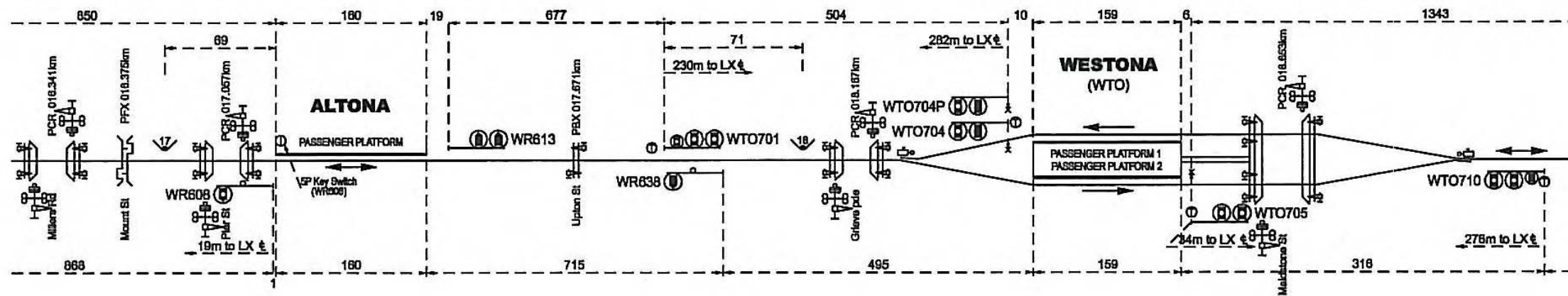

Quinn 2/6/2020
BILL UREN:
Manager Rail Safety

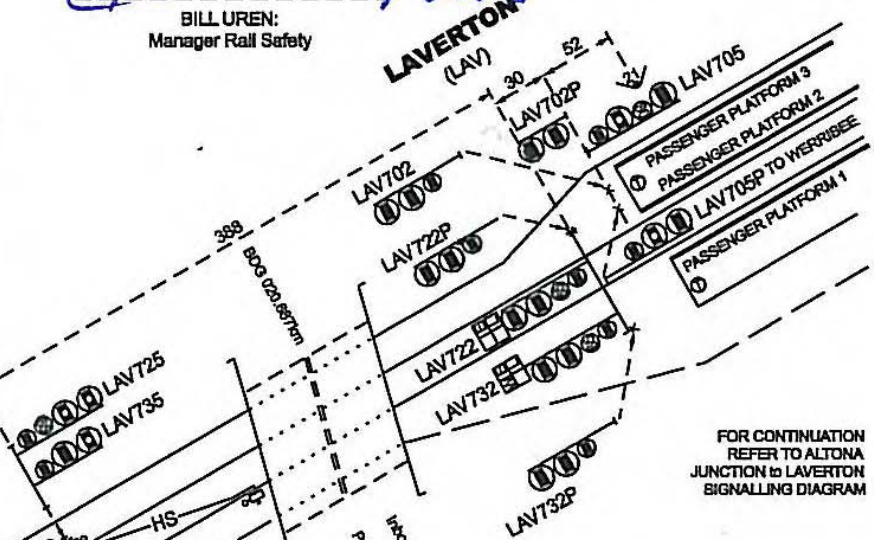

FOR CONTINUATION REFER TO ALTONA JUNCTION to LAVERTON SIGNALLING DIAGRAM

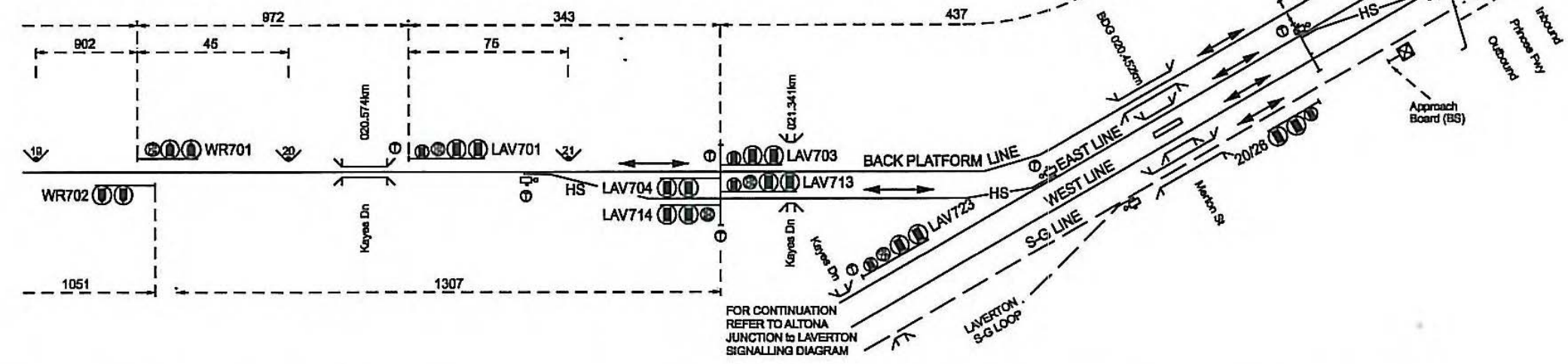

FOR CONTINUATION REFER TO ALTONA JUNCTION to LAVERTON SIGNALLING DIAGRAM