

## SEYMOUR SIGNALLING DIAGRAM No. 156/11

Showing Signal and Interlocking Arrangements to come into use on a date to be fixed by Circular which will be issued by:  
- the Manager Systems & Safeworking V/Line  
and the Operations Manager North/South ARTC

(Supersedes 50/11)

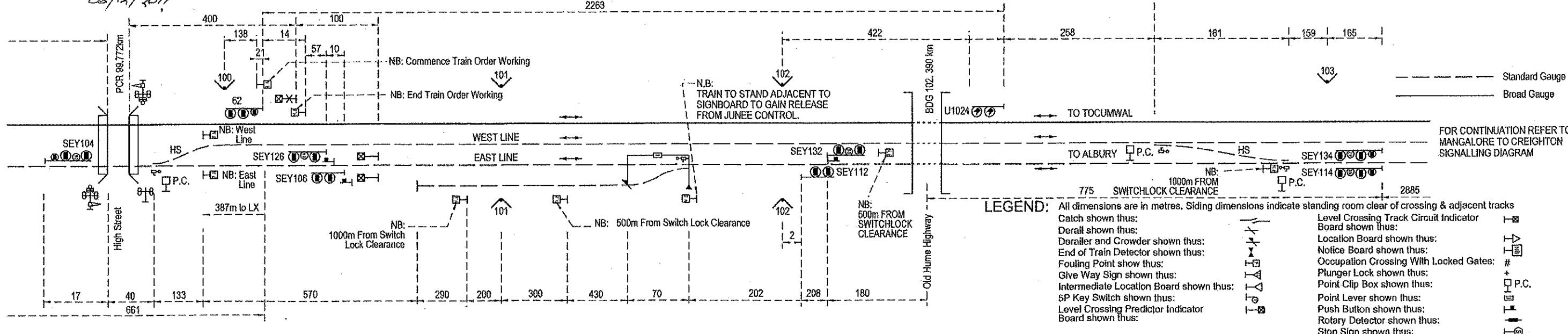
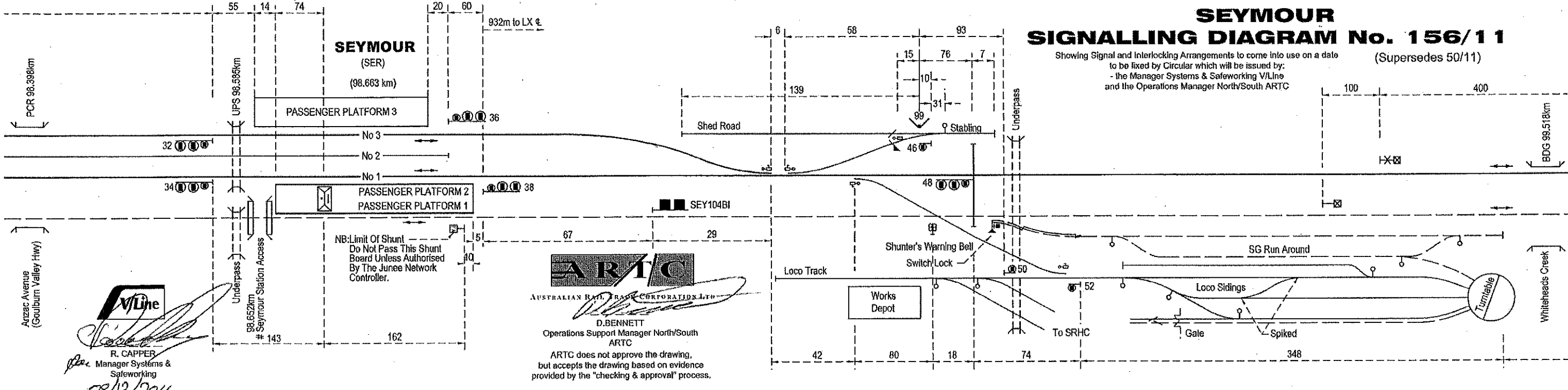

- LEGEND:** All dimensions are in metres. Siding dimensions indicate standing room clear of crossing & adjacent tracks
- Catch shown thus:
  - Derailed shown thus:
  - Derailer and Crowder shown thus:
  - End of Train Detector shown thus:
  - Fouling Point shown thus:
  - Give Way Sign shown thus:
  - Intermediate Location Board shown thus:
  - 5P Key Switch shown thus:
  - Level Crossing Predictor Indicator Board shown thus:
  - Level Crossing Track Circuit Indicator Board shown thus:
  - Location Board shown thus:
  - Notice Board shown thus:
  - Occupation Crossing With Locked Gates: #
  - Plunger Lock shown thus:
  - Point Clip Box shown thus:
  - Point Lever shown thus:
  - Push Button shown thus:
  - Rotary Detector shown thus:
  - Stop Sign shown thus:

FOR CONTINUATION REFER TO MANGALORE TO CREIGHTON SIGNALLING DIAGRAM