



AUSTRALIAN RAIL TRACK CORPORATION LTD

Pacific National

P Jerman
P JERMAN
OPERATIONS SUPPORT MANAGER
for ARTC

Wayne Richards
WAYNE RICHARDS
SAFETY RISK MANAGER
for PACIFIC NATIONAL

MAROONA (MNN)

SIGNALLING DIAGRAM No: 48/06

Showing Signal and Interlocking Arrangements to come into use on a date to be fixed by circular which will be issued by the Operations Support Manager for ARTC and Safety Risk Manager for Pacific National

- NOTES: All dimensions are in metres
Siding dimensions indicate standing room clear of crossing & adjacent tracks
- ⊠ Approach section Indicator shown thus:
 - ⊠ Block Point shown thus:
 - ⊠ Catch shown thus:
 - ⊠ Clearance Point shown thus:
 - ⊠ Derailed shown thus:
 - ⊠ Dual Controlled Point M/C shown thus:
 - ⊠ Fouling Point Indicator shown thus:
 - ⊠ Give Way Sign shown thus:
 - ⊠ Hayes Derailer and Crowder shown thus:
 - ⊠ Intermediate Location Board shown thus:
 - ⊠ Key Switch, V5PSW shown thus:
 - ⊠ Level Xing Predictor Indicator shown thus:

- ⊠ Lever shown thus:
- ⊠ Location Board shown thus:
- ⊠ Non Trailable Point M/C with Lock shown thus:
- ⊠ Notice Board shown thus:
- ⊠ Ped Crib Crossing shown thus:
- ⊠ Ped Xing Zig Zag shown thus:
- ⊠ Plunger Lock shown thus:
- ⊠ Rotary Point Detector shown thus:
- ⊠ Scotch Block shown thus:
- ⊠ Stop Sign shown thus:
- ⊠ Trailable Point Indicator shown thus:

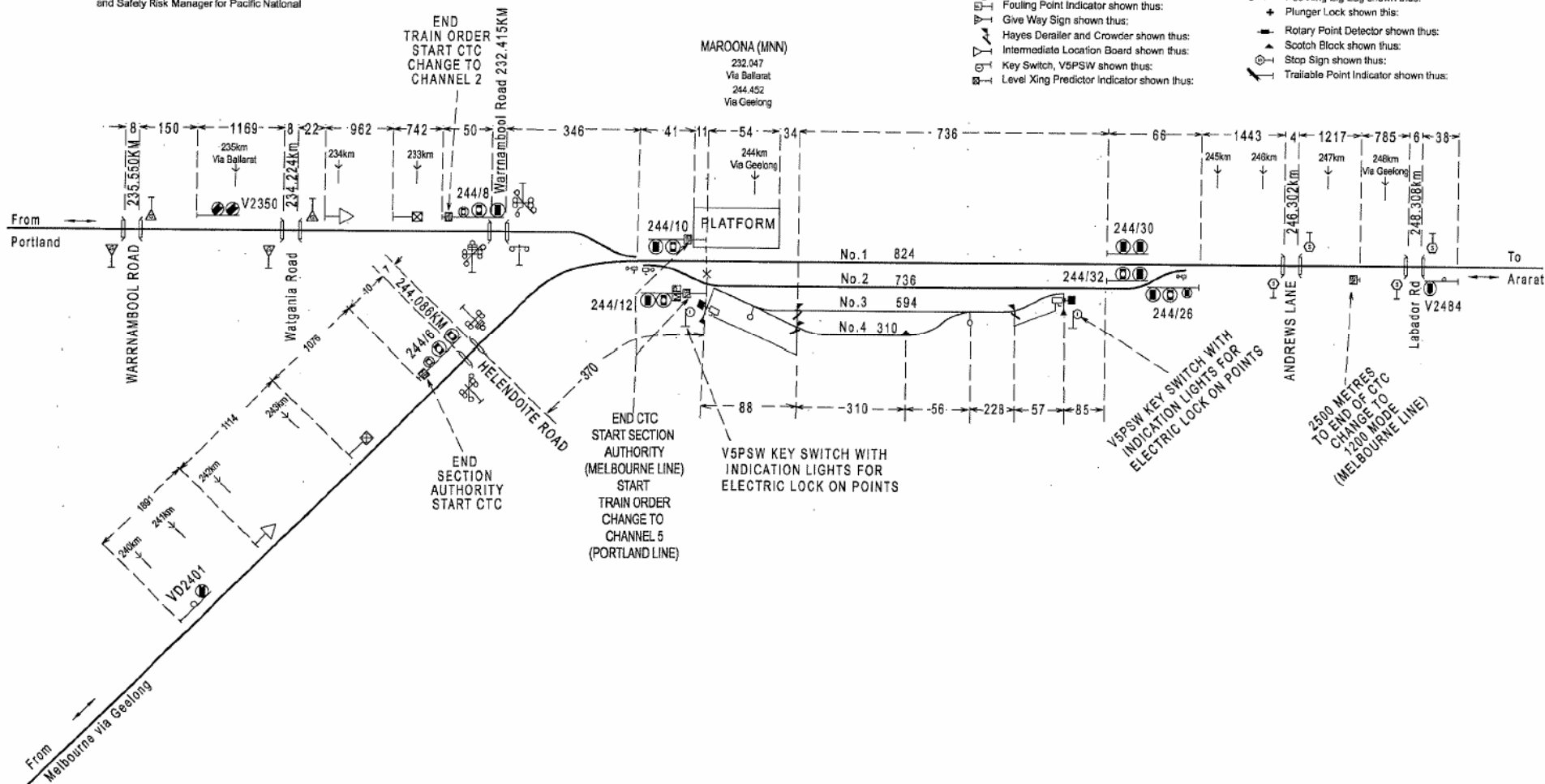

NOTE: Redrawn & Revised, based on field survey. This drawing supersedes VS01/0427, dated 16-07-2003, which is now cancelled.