

Rupert Capper
 RUPERT CAPPER
 MANAGER COMPLIANCE & SAFEWORKING

24th DECEMBER 2017



MARYBOROUGH (MYB)

SIGNALLING DIAGRAM No: 70/17
 (Replaces 48/17)

Showing Signal and Interlocking Arrangements to come into use on a date which will be fixed by Circular which will be issued by the Manager Compliance and Safeworking

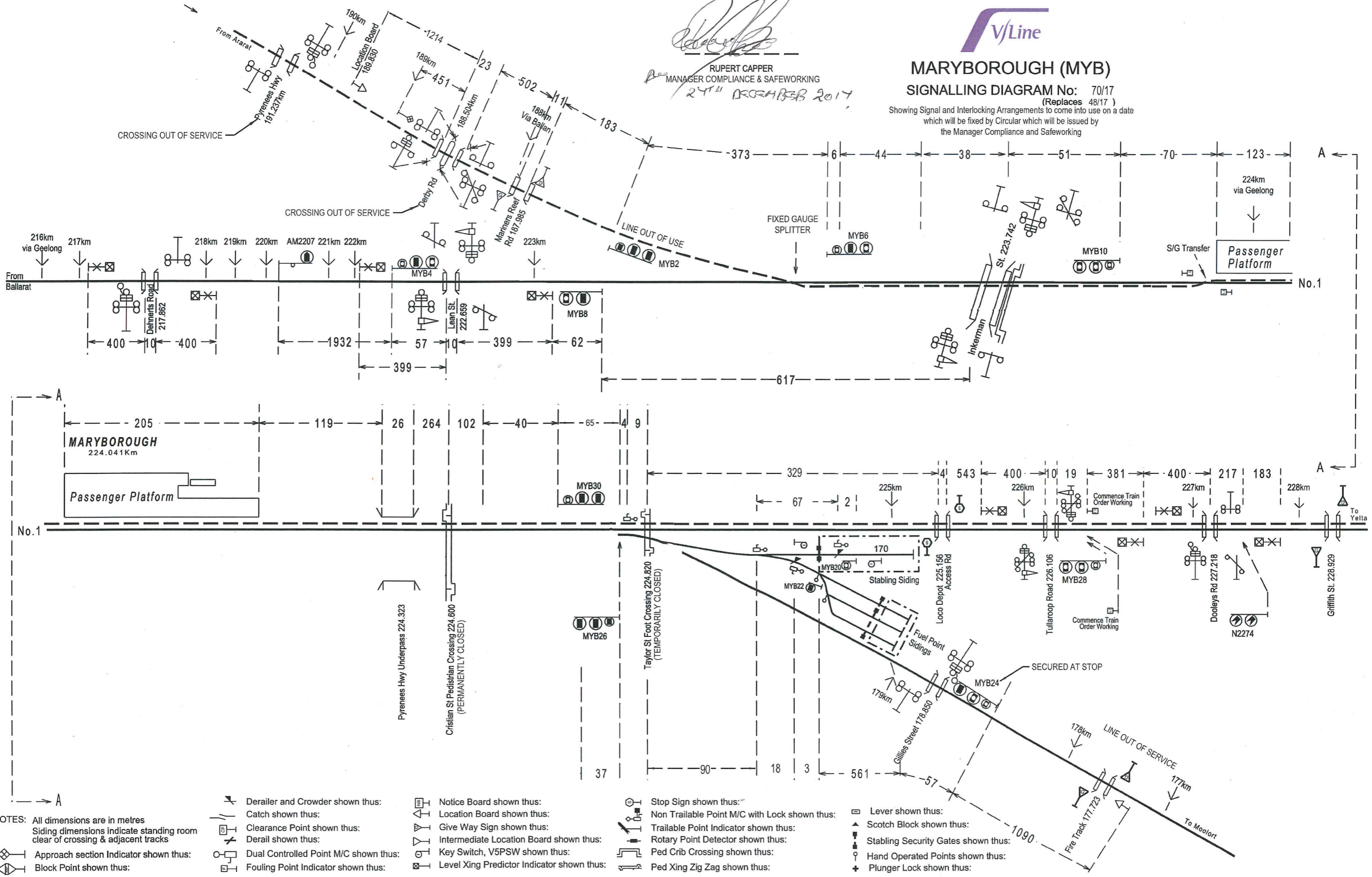

IOTES: All dimensions are in metres
 Siding dimensions indicate standing room clear of crossing & adjacent tracks

- Approach section Indicator shown thus:
- Block Point shown thus:

- Derailer and Crowder shown thus:
- Catch shown thus:
- Clearance Point shown thus:
- Derail shown thus:
- Dual Controlled Point M/C shown thus:
- Fouling Point Indicator shown thus:

- Notice Board shown thus:
- Location Board shown thus:
- Give Way Sign shown thus:
- Intermediate Location Board shown thus:
- Key Switch, V5PSW shown thus:
- Level Xing Predictor Indicator shown thus:

- Stop Sign shown thus:
- Non Trailable Point M/C with Lock shown thus:
- Trailable Point Indicator shown thus:
- Rotary Point Detector shown thus:
- Ped Crib Crossing shown thus:
- Ped Xing Zig Zag shown thus:

- Lever shown thus:
- Scotch Block shown thus:
- Stabling Security Gates shown thus:
- Hand Operated Points shown thus:
- Plunger Lock shown thus: